

PLANCHER COFRADAL

NOTA : Pour VIDE SANITAIRE, rajout polyuréthane en sous face, suivant feuillet de décomposition d'un plancher COFRADAL

COFRADAL 200

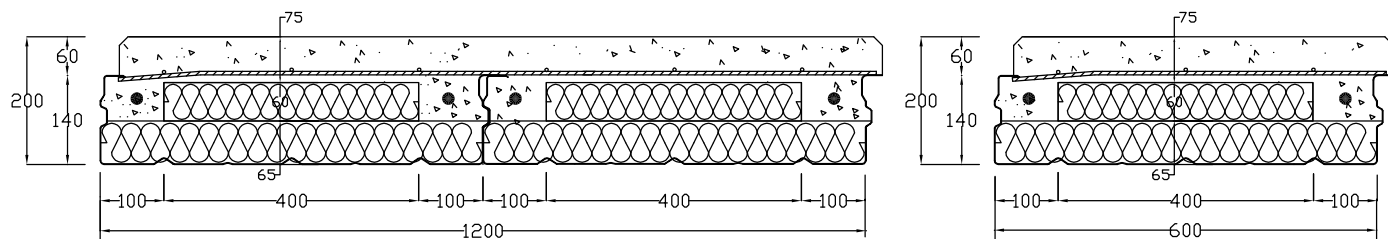

COFRADAL 230

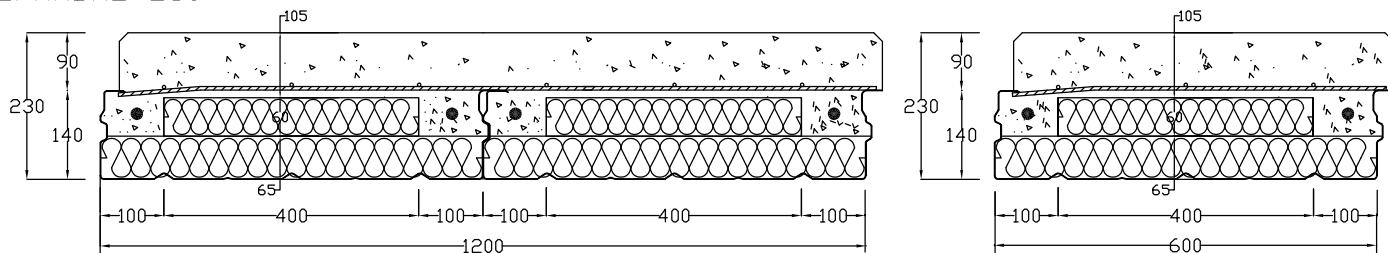

COFRADAL 260

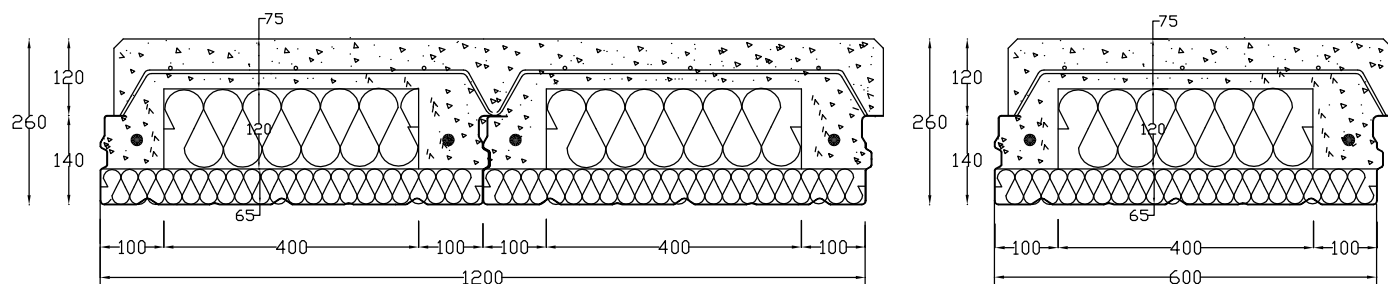

COFRADAL 200 PAC

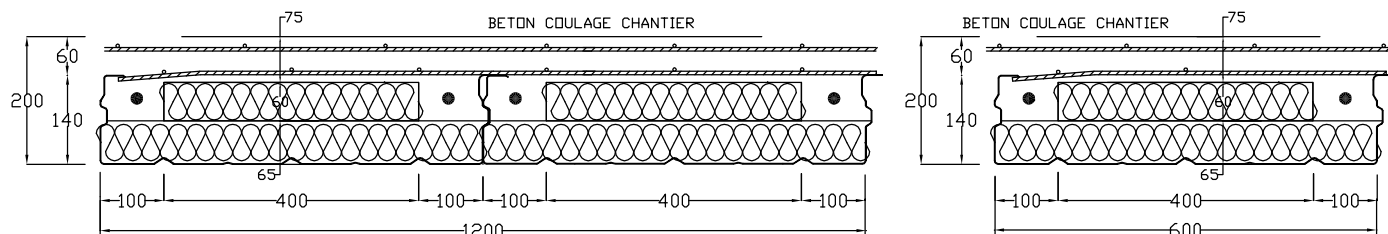

COFRADAL 230 PAC

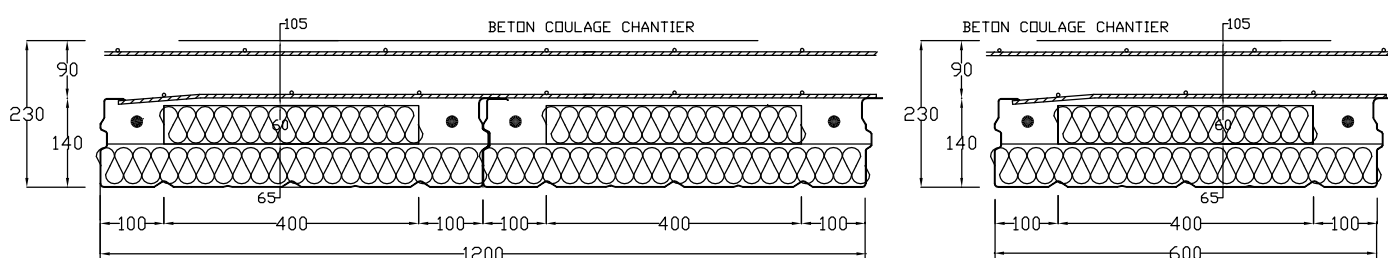

COFRADAL 260 PAC

